

San Diego State University

Main Campus Master Plan Enrollment: 35,000 FTE

Main Campus Master Plan Approved by the Board of Trustees: May 1963

Main Campus Master Plan Revision approved by the Board of Trustees: June 1967, July 1971, November 1973, July 1975, May 1977, November 1977, September 1978, September 1981, May 1982, July 1983, May 1984, July 1985, January 1987, July 1988, July 1989, May 1990, July 1990, September 1998, May 1999, March 2001, May 2011, May 2017, May 2018

1. Art - South	90. Arts and Letters	IMPERIAL VALLEY Off-Campus Center,
2. Hepner Hall	90a. Parking 14	Imperial Valley Campus - Brawley
3. Geology - Mathematics - Computer Science	91. Tenochca Hall (Coed. Residence)	Master Plan Enrollment: 850 FTE
3a. Geology - Mathematics - Computer Science Addition	91b. Tenochca Community Space	Master Plan approved by the Board of Trustees: September 2003
6. Education	91c. Tula Community Center	
8. Storm Hall	92. <i>Art Gallery</i>	101. Initial Building (<i>Brandt Building</i>)
8a. Storm Hall West	93. Chapultepec Hall (Coed. Residence)	102. <i>Brawley Sciences Building</i>
8b. Charles Hostler Hall	94. Tepeyac (Coed. Residence)	103. <i>Academic Building III</i>
10. Life Science - South	95. Tacuba (Coed. Residence)	104. <i>Library</i>
11. Little Theatre	96. Parking 3	105. <i>Computer Building</i>
12. Communication	97. Rehabilitation Center	106. <i>Auditorium</i>
13. Physics	98. Logistical Services	107. <i>Administration</i>
14. Physics - Astronomy	99. Parking 4	108. <i>Academic Building IV</i>
15. University Police	100. Villa Alvarado Hall (Coed. Residence)	109. <i>Student Center</i>
16. Peterson Gymnasium	101. Maintenance Garage	110. <i>Energy Museum</i>
17. Physical Sciences	101a. Building A	111. <i>Faculty Office</i>
18. Nasatir Hall	102. Cogeneration/Chill Plant	112. <i>Agricultural Research</i>
18a. Aztec Shops Terrace	103. Recreation Field	
19. Engineering	104. <i>Academic Building A</i>	IMPERIAL VALLEY Off-Campus Center,
20. Exercise and Nutritional Sciences Annex	105. <i>Academic Building B</i>	Imperial Valley Campus - Calexico
21. Exercise and Nutritional Sciences	106. <i>Academic Building C - Education</i>	Master Plan Enrollment: 850 FTE
23. Facilities Services Boiler Shop	107. <i>College of Business</i>	Master Plan approved by the Board of Trustees: February 1980
24. Facilities Services	109. University Children's Center	
25. Cogeneration Plant	110. Growth Chamber	Master Plan Revision approved by the Board of Trustees: September 2003
26. Hardy Memorial Tower	111. <i>Prebys Stage</i>	
27. Professional Studies and Fine Arts	111a. <i>Amenities Building</i>	1. North Classroom Building
28. Atkinson Hall	112. Resource Conservation	2. Administration Building
29. Student Services - West	113. Waste Facility	2a. Art Gallery
30. Administration	114. Engineering and Interdisciplinary Sciences	3. Auditorium / Classrooms
31. Calpulli (Counseling, Disabled and Student Health Services)	115. <i>Physical Plant/Corporation Yard</i>	4. Classroom Building
32. Charles B. Bell Jr. Pavilion	116. <i>School of Communication Addition A</i>	5. Library
33. Cuicacalli (Dining)	117. <i>School of Communication Addition B</i>	5a. Library Addition
34. Ellen Ochoa Pavilion	118. <i>School of Communication Addition C</i>	6. Physical Plant
35. Life Science - North	119. <i>Life Science North Replacement</i>	7. Computer Building
36. Dramatic Arts	135. Donald P. Shiley BioScience Center	9. Faculty Offices Building East
37. Lamden Hall	140. <i>Special Events Operations Center</i>	10. Faculty Offices Building West
38. North Education	161. <i>Alvarado Park - Academic Building 1</i>	20. Student Center
38a. North Education 60	162. <i>Alvarado Park - Academic Building 2</i>	21. <i>Classroom Building/Classroom Building East</i>
39. Faculty/Staff Club	163. <i>Alvarado Park - Academic Building 3</i>	22. <i>Classroom Building South</i>
41. Scripps Cottage	164. <i>Alvarado Park - Academic Building 4</i>	201. Classroom Buildings (3 temporaries)
42. Speech, Language and Hearing Sciences	166. <i>Villa Alvarado Expansion</i>	
44. Facilities Services Chill Plant	167. Huaxyacac Residence Hall	MISSION VALLEY Site
45. Aztec Shops Bookstore	170. <i>Alvarado Park - Parking Structure</i>	Master Plan Enrollment: 15,000 FTE
46. Maya Hall	171. <i>Alvarado Park - Research Building 1</i>	Master Plan approved by the Board of Trustees: January 2020
47. Olmeca Hall (Coed. Residence)	172. <i>Alvarado Park - Research Building 2</i>	
51. Zura Hall (Coed. Residence)	173. <i>Alvarado Park - Research Building 3</i>	500. Snapdragon Stadium
52. Conrad Prebys Aztec Student Union	180. <i>Adobe Falls Lower Village</i>	502. <i>Hospitality</i>
53. Music	181. <i>Adobe Falls Upper Village</i>	506. <i>Office/Research and Innovation/Retail</i>
54. Love Library	182. South Campus Plaza Parking Building 3	508. <i>Office/Research and Innovation/Retail</i>
55. Parking 1	183. South Campus Plaza Building 1	509. <i>Residential</i>
56. Art - North	184. South Campus Plaza Building 2	510. <i>Residential</i>
58. Adams Humanities	185. <i>South Campus Plaza Building 5</i>	511. <i>Residential</i>
59. Student Services - East	186. <i>South Campus Plaza Building 4</i>	512. <i>Residential & Retail Project #1</i>
60. Chemical Sciences Laboratory	187. <i>South Campus Plaza Building 6</i>	513a. <i>Affordable Housing Project #1</i>
62. <i>Student Housing, Phase I (600 beds)</i>	188. <i>South Campus Plaza Building 7</i>	513b. <i>Residential</i>
63. <i>Student Housing, Phase II (700 beds)</i>	240. Transit Center	514. <i>Residential</i>
64. <i>Student Housing, Phase II (700 beds)</i>	306. Facilities Services Grounds Storage	515. <i>Residential</i>
67. Fowler Athletics Center/Hall of Fame	310. EHS Storage Shed	516. <i>Residential/Retail</i>
69. Aztec Recreation Center	311. Substation D	517. <i>Residential</i>
69a. Arena Meeting Center	312. Substation B	518. <i>Residential</i>
70. Viejas Arena at Aztec Bowl	313. Substation A	519. <i>Residential/Retail</i>
70a. Arena Ticket Office	316. Stadium Annex (Facilities Services Storage #5)	520. <i>Residential</i>
71. Open Air Theater	317. Landscape Services	521. <i>Residential</i>
71a. Open Air Theater Hospitality House	318. Landscape Services Equipment	522. <i>Residential</i>
71c. Open Air Theater Upper Restrooms	907. 6475 Alvarado Road	524. <i>Office/Research and Innovation</i>
71e. Open Air Theater Concessions	908. 6505 Alvarado Road	525. <i>Office/Research and Innovation</i>
71h. Open Air Theater Office	909. 6495 Alvarado Road	526. <i>Office/Research and Innovation</i>
72. The KPBS Conrad Prebys Media Complex at Copley Center	910. 6330 Alvarado Road	527. <i>Office/Research and Innovation</i>
	925. Granada Apartments	528. <i>Office/Research and Innovation/Retail</i>
	932. University Towers	529. <i>Office/Research and Innovation</i>
		530. <i>Office/Research and Innovation</i>
72a. Gateway Center		531. <i>Office/Research and Innovation</i>
72b. Extended Studies Center		532. <i>Office/Research and Innovation</i>
73. Racquetball Courts		533. <i>Office/Research and Innovation</i>
74. International Student Center		534. <i>Office/Research and Innovation</i>
74a. Global Education Office		535. <i>Office/Research and Innovation</i>
74b. Faculty International Engagement Office		537. <i>Office/Research and Innovation</i>
74t. SDSU Passport Office		538. <i>Office/Research and Innovation/Retail</i>
76. Love Library Addition/Manchester Hall		(Garage parking structures integral to Campus Residential buildings)
77. Tony Gwynn Stadium		
78. Softball Stadium		
79. Parking 6		
80. Parking Structure 7/Sports Deck		
82. Parking 12		
86. Aztec Aquaplex		
87. Aztec Tennis Center		
88. Parma Payne Goodall Alumni Center		
89. Jeff Jacobs JAM Center		

LEGEND: Existing Facility / Proposed Facility

NOTE: Existing building numbers correspond with building numbers in the Space and Facilities Data Base (SFDB)

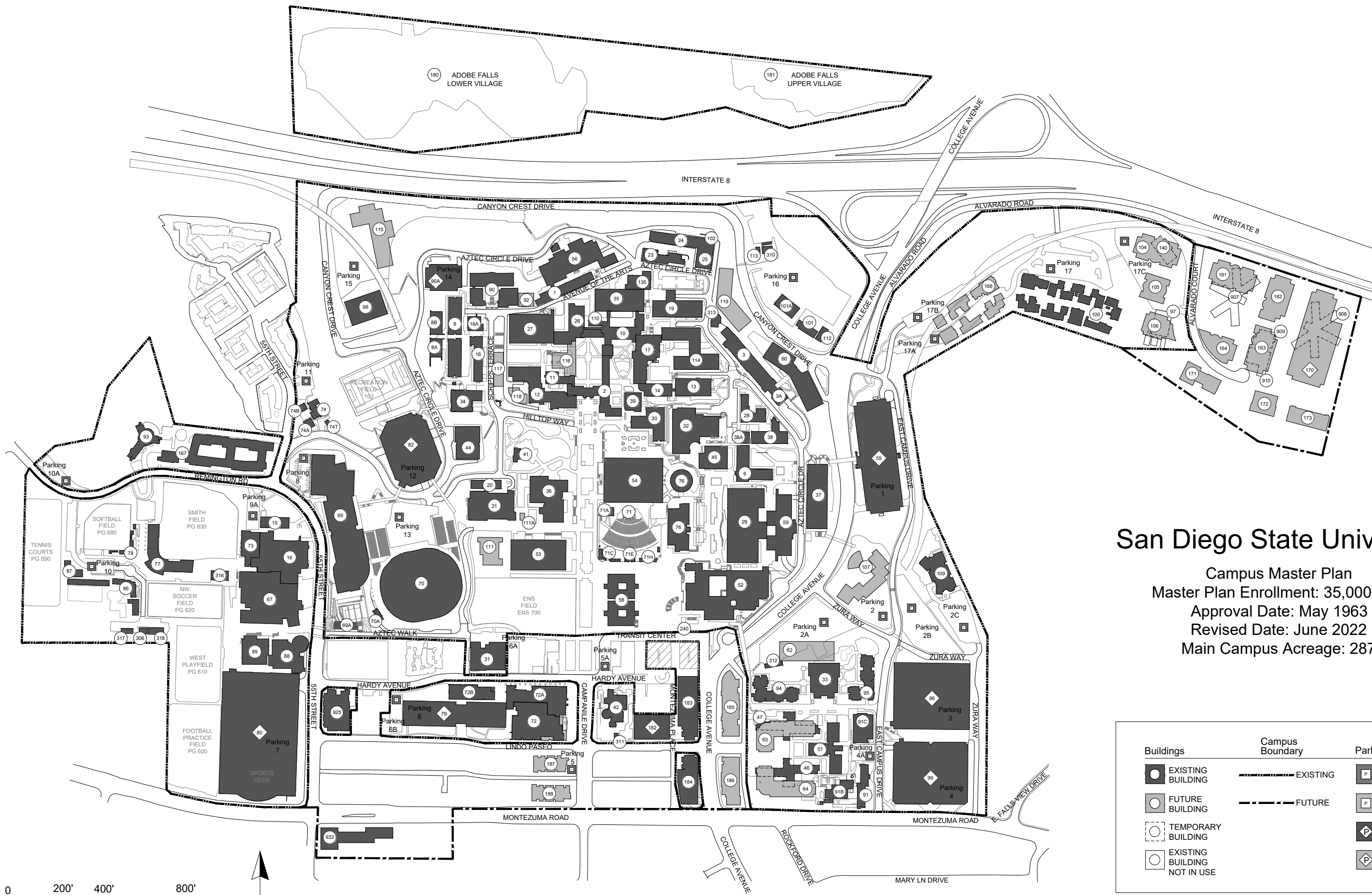

San Diego State University

Campus Master Plan
 Master Plan Enrollment: 35,000 FTE
 Approval Date: May 1963
 Revised Date: June 2022
 Main Campus Acreage: 287

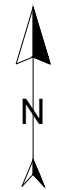

Buildings	Campus Boundary	Parking
EXISTING BUILDING	EXISTING	EXISTING LOT
FUTURE BUILDING	FUTURE	FUTURE LOT
TEMPORARY BUILDING		EXISTING STRUCTURE
EXISTING BUILDING NOT IN USE		FUTURE STRUCTURE

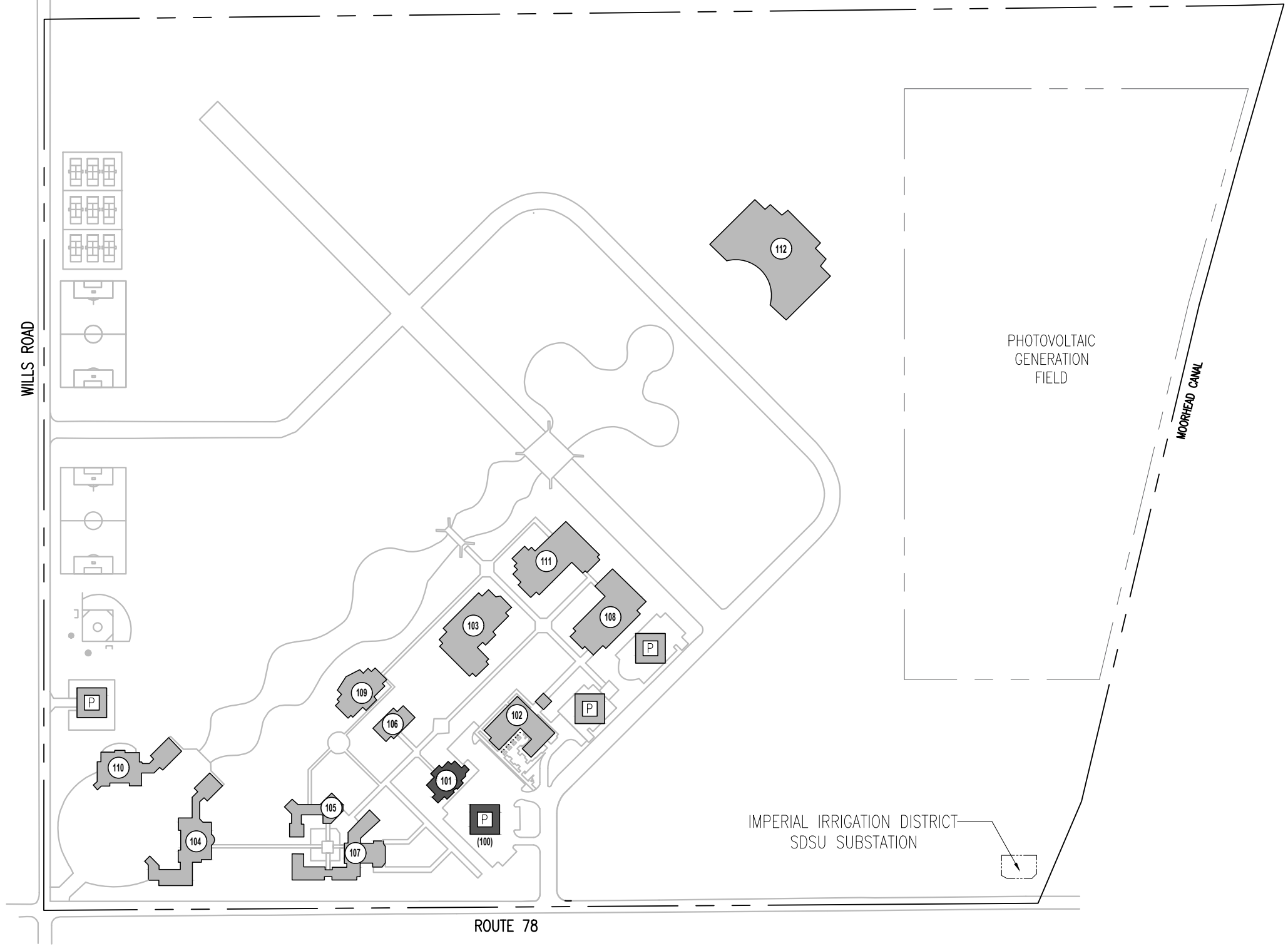

San Diego State University
 Imperial Valley Campus - Brawley
 Campus Master Plan
 Master Plan Enrollment: 850 FTE
 Approval Date: September 2003
 Campus Acreage: 232

Buildings	Campus Boundary	Parking
EXISTING BUILDING	EXISTING	EXISTING LOT
FUTURE BUILDING	FUTURE	FUTURE LOT
TEMPORARY BUILDING		EXISTING STRUCTURE
EXISTING BUILDING NOT IN USE		FUTURE STRUCTURE

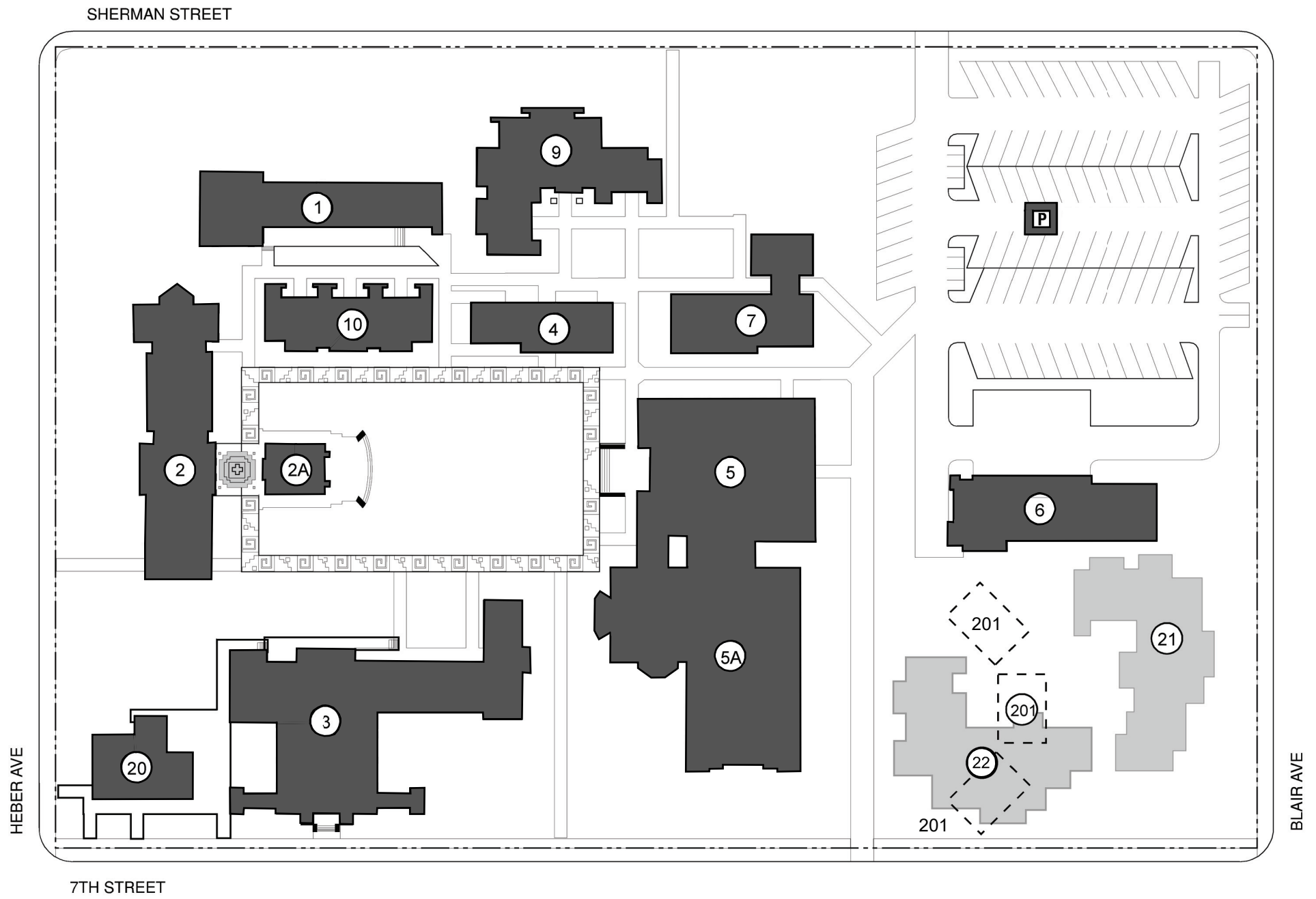

San Diego State University

Imperial Valley Campus - Calexico
Campus Master Plan

Master Plan Enrollment: 850 FTE
Approval Date: February 1980

Revised Date: September 2003
Campus Acreage: 8.4

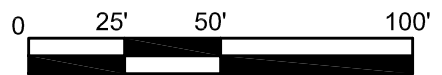
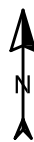

Buildings	Campus Boundary	Parking
EXISTING BUILDING	EXISTING	EXISTING LOT
FUTURE BUILDING	FUTURE	FUTURE LOT
TEMPORARY BUILDING		EXISTING STRUCTURE
EXISTING BUILDING NOT IN USE		FUTURE STRUCTURE

San Diego State University

Mission Valley Site

Physical Master Plan

Master Plan Enrollment: 15,000 FTES

Approval Date: January 2020

Mission Valley Site Acreage: 135

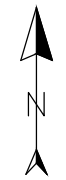
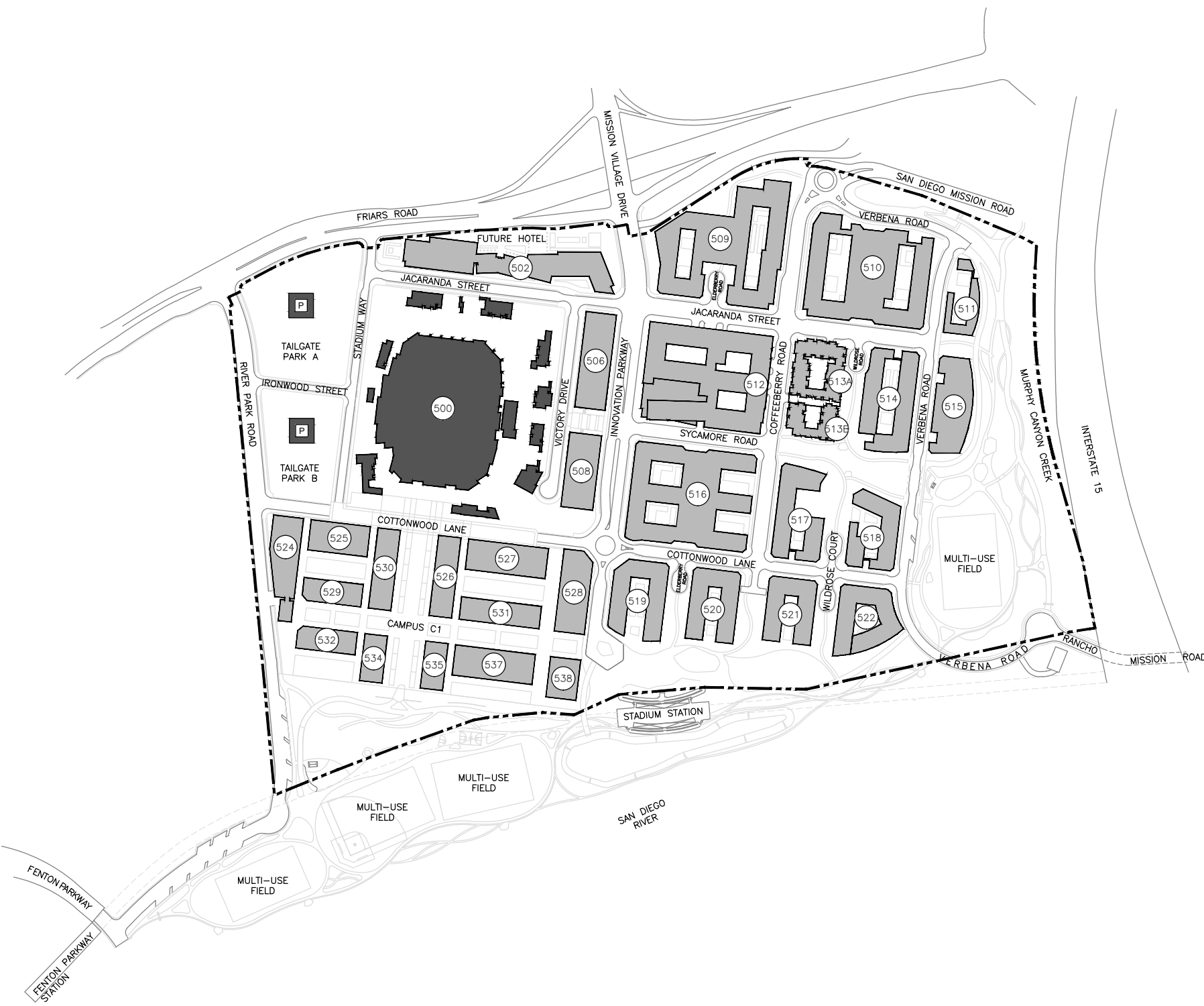

Buildings	Campus Boundary	Parking
EXISTING BUILDING	EXISTING	EXISTING LOT
FUTURE BUILDING	FUTURE	FUTURE LOT
TEMPORARY BUILDING		EXISTING STRUCTURE
EXISTING BUILDING NOT IN USE		FUTURE STRUCTURE